



## Quadrangle Mews

Stanmore

£350,000

Davidson Frost-Wellings are delighted to introduce to the market this stunning first floor maisonette on Quadrangle Mews. This property is in immaculate condition throughout and comprises one double bedroom, a separate kitchen and a modern bathroom.

Quadrangle Mews is located off the leafy Belmont Lane it is within walking distance of The Broadways shops and restaurants

Harrow council tax band D  
Leasehold 963 years remaining  
Service charge £1,275 pa

### Viewing

Please contact our Davidson Frost-Wellings Office on 020 8954 8806 if you wish to arrange a viewing appointment for this property or require further information.

- One bedrooms
- Separate kitchen
- Long lease
- Lots of natural light
- sought after location
- First floor



## Floor Plan

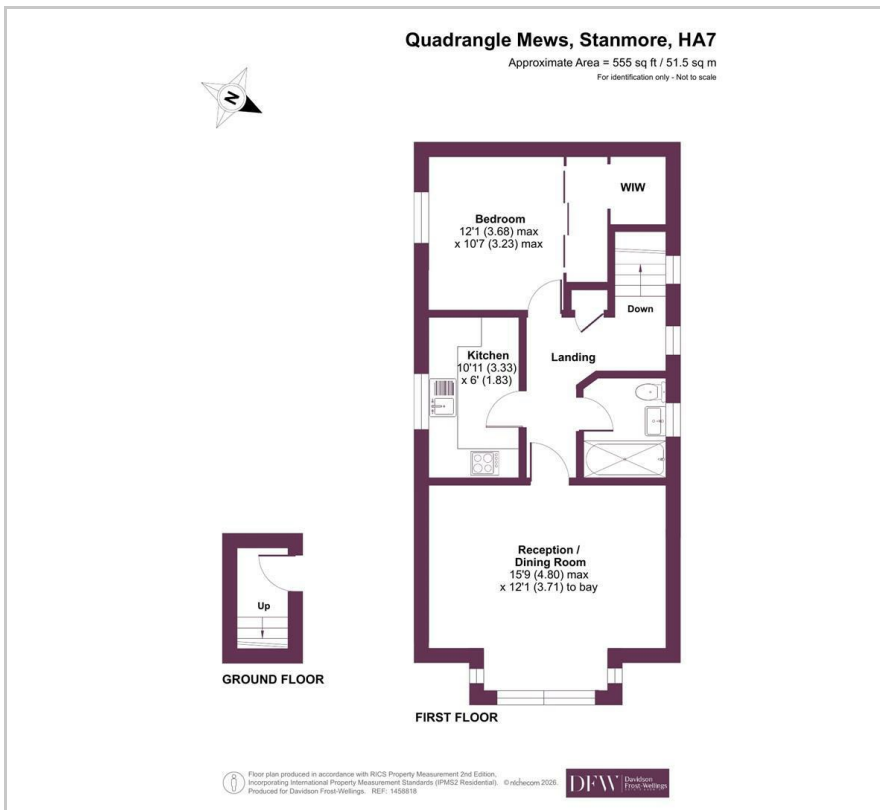

## Area Map



### Energy Efficiency Rating

	Current	Potential
<i>Very energy efficient - lower running costs</i>		
(92 plus) <b>A</b>		
(81-91) <b>B</b>		
(69-80) <b>C</b>	<b>73</b>	<b>73</b>
(55-68) <b>D</b>		
(39-54) <b>E</b>		
(21-38) <b>F</b>		
(1-20) <b>G</b>		
<i>Not energy efficient - higher running costs</i>		
<b>England &amp; Wales</b>	EU Directive 2002/91/EC	



These particulars, whilst believed to be accurate are set out as a general outline only for guidance and do not constitute any part of an offer or contract. Intending purchasers should not rely on them as statements of representation of fact, but must satisfy themselves by inspection or otherwise as to their accuracy. No person in this firm's employment has the authority to make or give any representation or warranty in respect of the property.